

CRAMER HALL

DOUBLE (4 PERSON SUITE)



EVERY ROOM INCLUDES THE FOLLOWING ITEMS



TWO SETS OF BUNKED BEDS
VINYL MATTRESSES
BED FRAME/SPRINGS

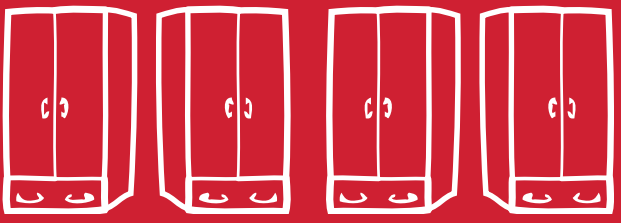

FOUR
WARDROBES

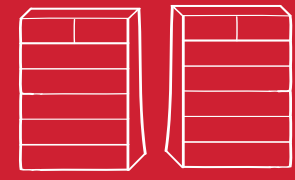

TWO
SIX DRAWER
DRESSERS

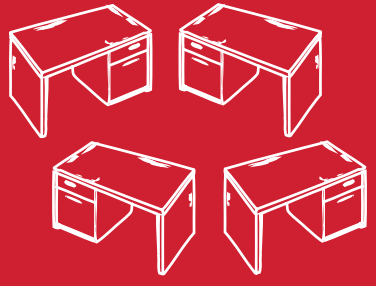

FOUR
DESKS

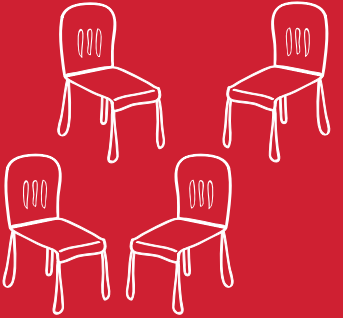

FOUR DESK
CHAIRS

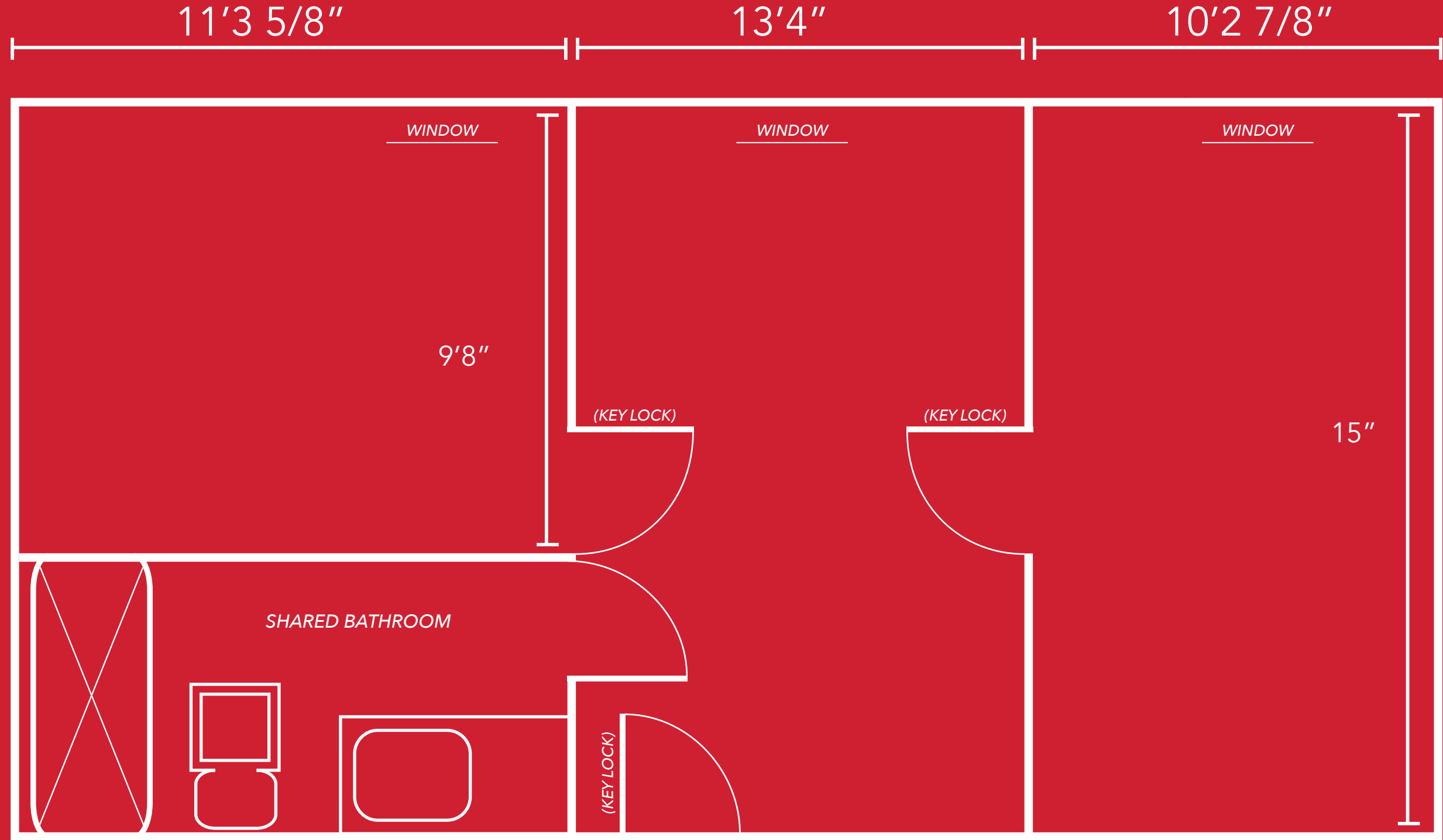

LAYOUTS ARE NOT TO SCALE